



Introduction

This document will assist a user to identify the various parts found on the standard 1.0 meter conveyor of Agilent Medalist SJ50 Series 2 and Series 3 AOI. There is 2 difference generations of conveyor available. The main difference between the 2 generations of conveyor is the board clamp/stop assembly.

Fig 1 shows a conveyor fitted with the new board clamp/stop assembly, while Fig 2 show a conveyor fitted with the old board clamp/stop assembly.

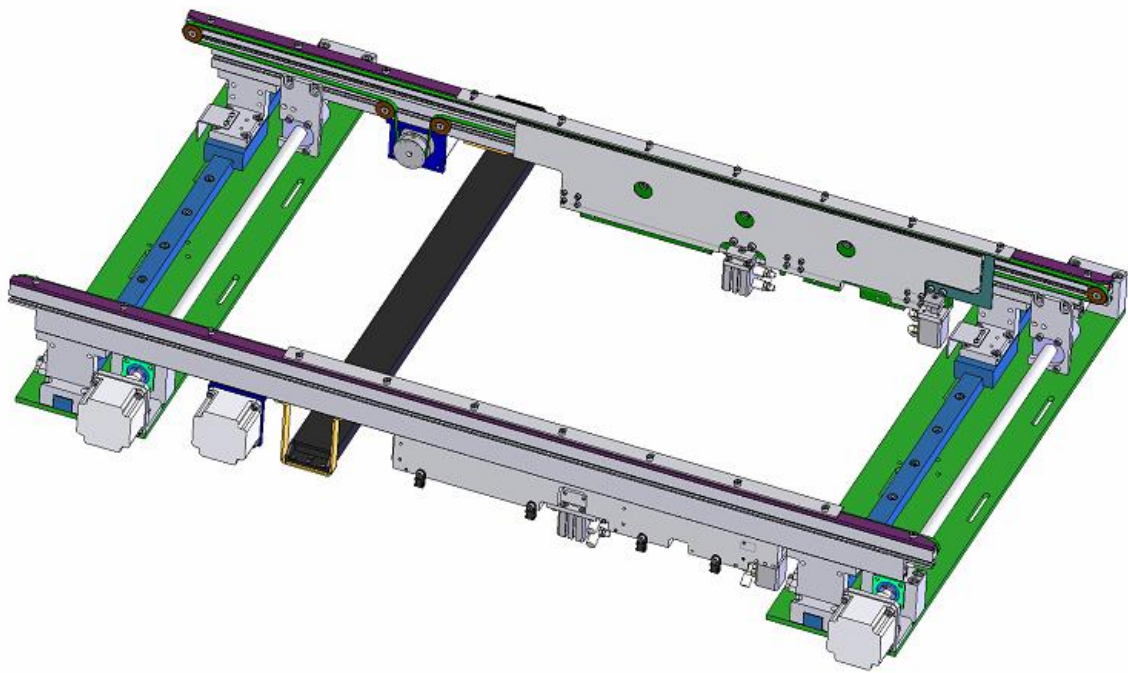

Fig 1

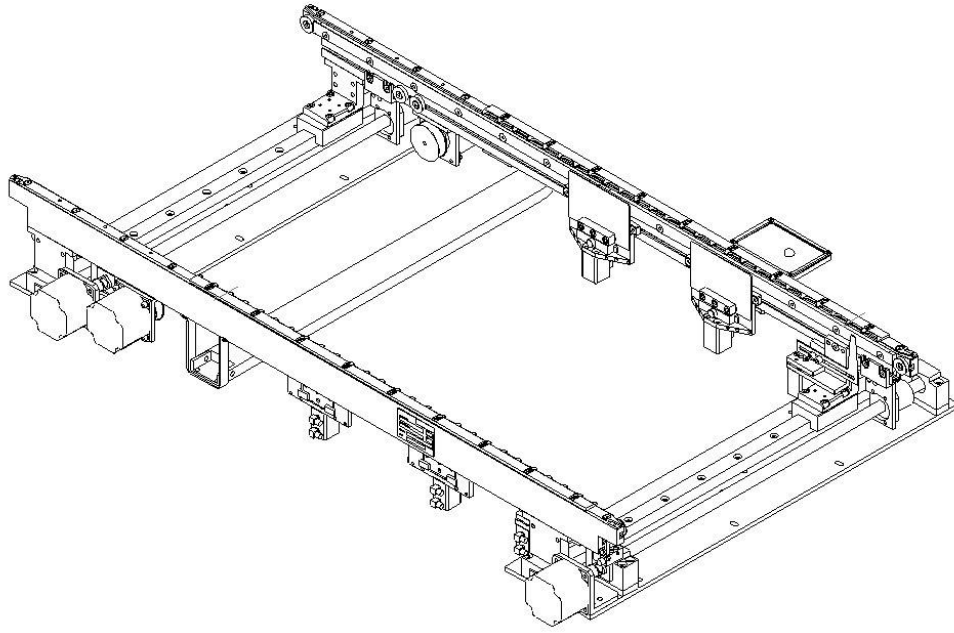
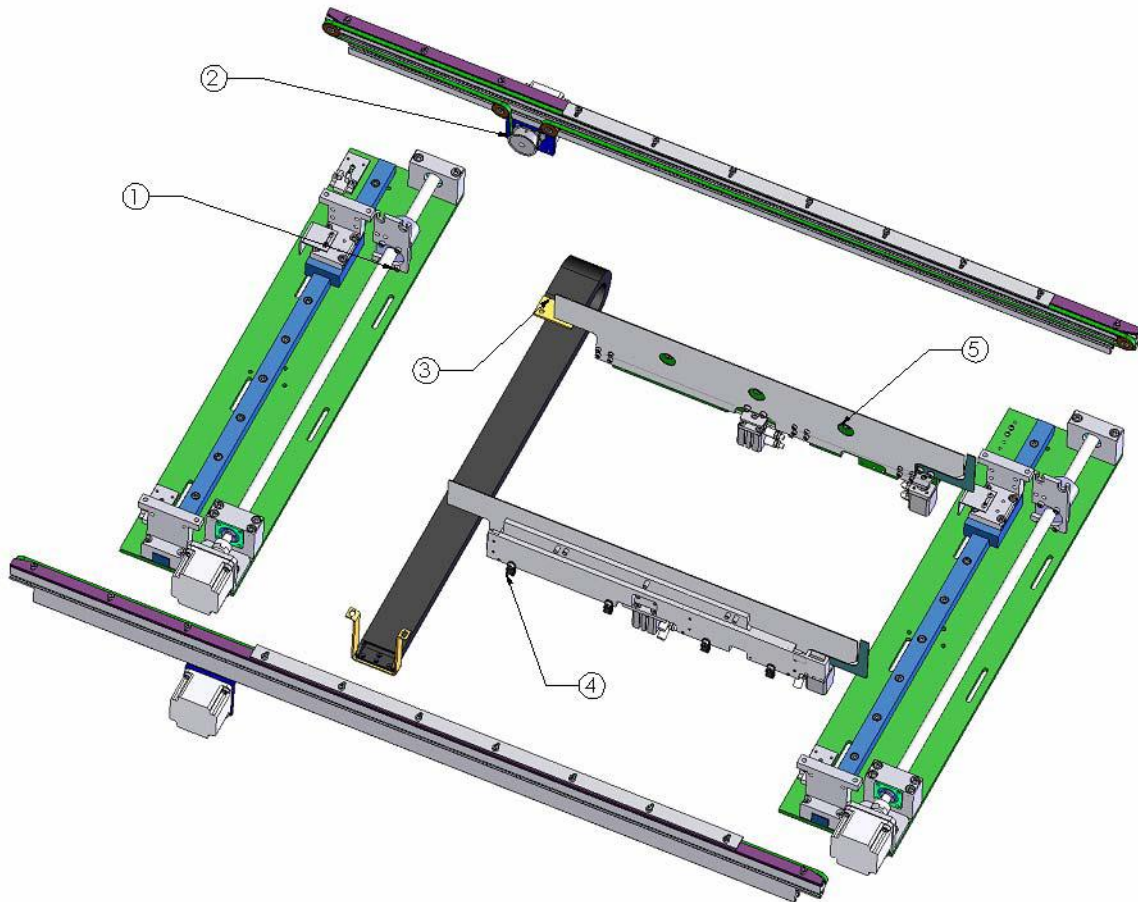

Fig 2



Part Identification for conveyor with new board clamp/stop assembly



Item No.	Qty	Agilent Part Number	Description
1	2	5186-4951	Base Plate Assembly
2	2	5186-1027/1028	Fixed/Adjustable Rail Assembly
3	1	5186-1089	Cable Chain
4	1	5186-5485	Fixed Rail Clamp/Stop Assembly
5	1	5186-5474	Adjustable Rail Clamp/Stop Assembly



5186-1027/1028 Fixed/Adjustable Rail Assembly

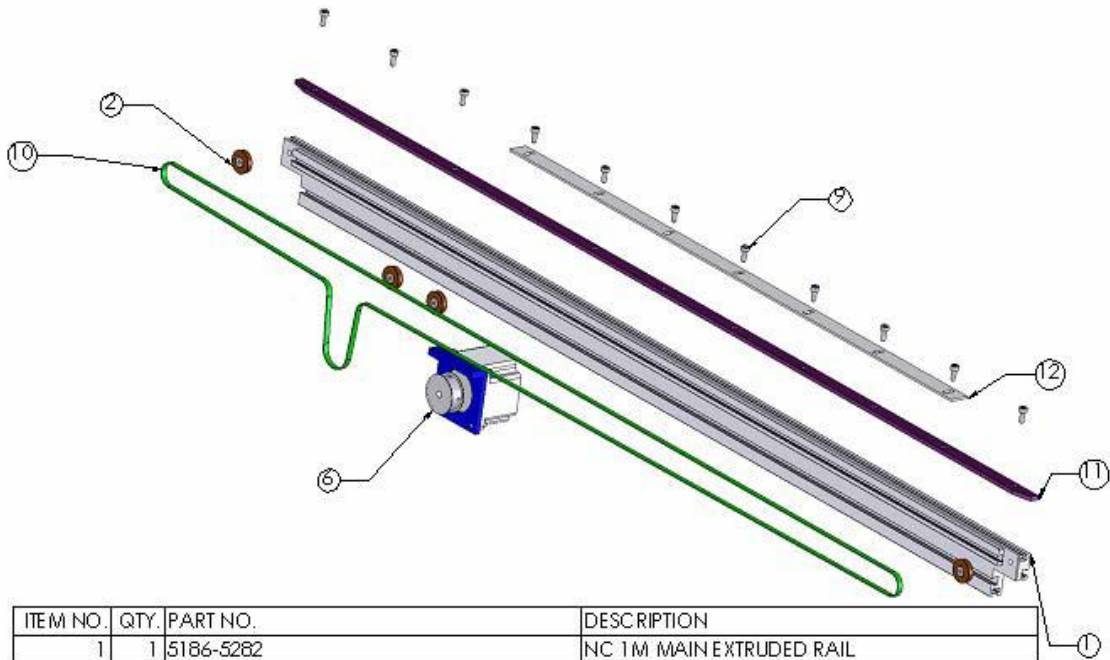

ITEM NO.	QTY.	PART NO.	DESCRIPTION
1	1	5186-5282	NC 1M MAIN EXTRUDED RAIL
2	4	5186-5281	NC BELT PULLY
6	1	5186-1029	NC SHUTTLE BELT DRME MOTOR
9	11	5186-3989	M4x8 SHCS A2
10	1	5186-5280	HAM-5P BELT
11	1	5186-5487	1 M STANDARD CONVEYOR 1 M GUIDE RAIL
12	1	5186-5486	CLAMP RAIL



5186-4951 Base Plate Assembly

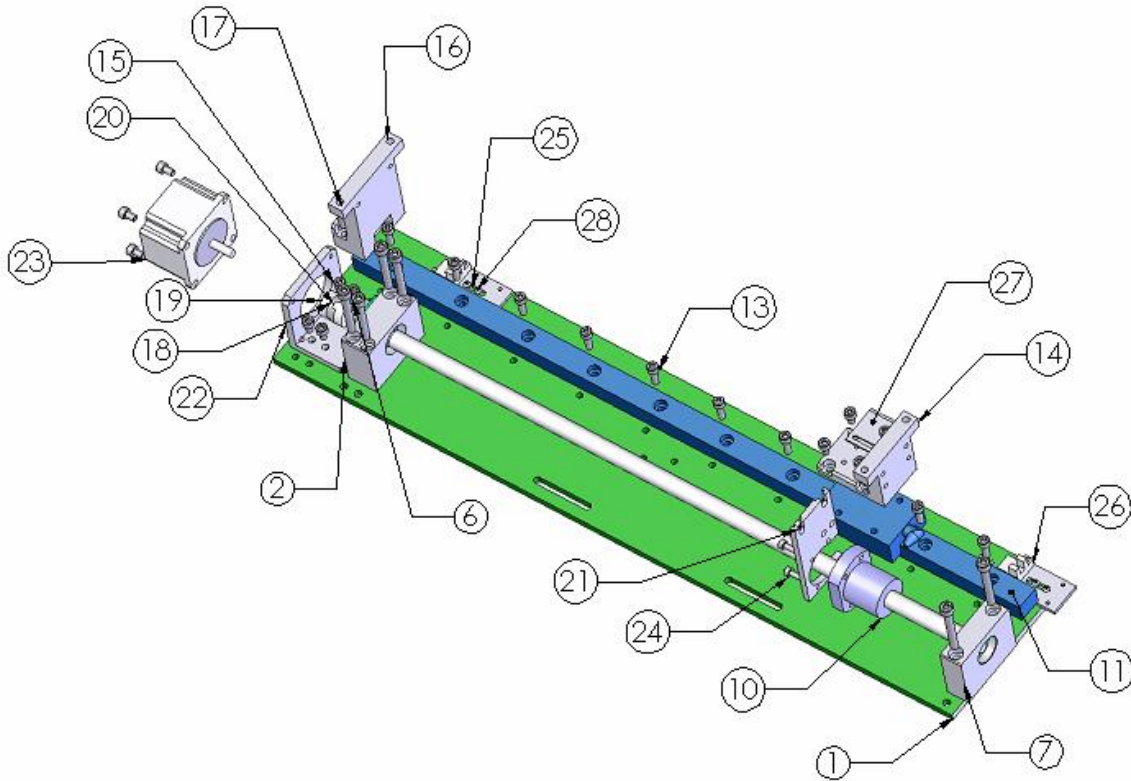

Item No.	Qty	Agilent Part Number	Description
1	1	5186-5075	Base Plate
2	1	5186-5288	AWA Fixed Support
6	6	5186-4098	M6X40 SHC A2
7	1	5186-5287	AWA Adjustable Support
10	1	5186-4544	Ballscrew
11	1	5186-1665	Linear Bearing 605MM6R SSR20
13	10	5186-2901	M6X12 SHC A2
14	1	5186-0156	NC Adjustable Rail Mounting Block
15	12	5186-2901	M6X12 SHC A2
16	1	5186-0157	NC Fixed Rail Mounting Block
17	2	5186-3991	M6X30 SHC A2
18	1	5186-2398	Oldham Thru Bore Disc 8mm
19	1	5186-2396	Oldham Thru Bore Hub 6.35mm
20	1	5186-2397	Oldham Thru Bore Hub 8mm
21	1	5186-0283	NC 1M AWA Nutbracket
22	1	5186-0285	NC 1M AWA Motor mount
23	1	5186-2395	T+P Conveyor Motor (L701)
24	4	5186-4016	M4X16 SHC A2



25	2	5186-0160	NC Opto Sensor Mtg Plate
26	2	5186-1921	AWA Sensor
27	1	5186-0537	NC Int Dual Lane AWA Flag
28	6	5186-4006	M8X10 SHC A2

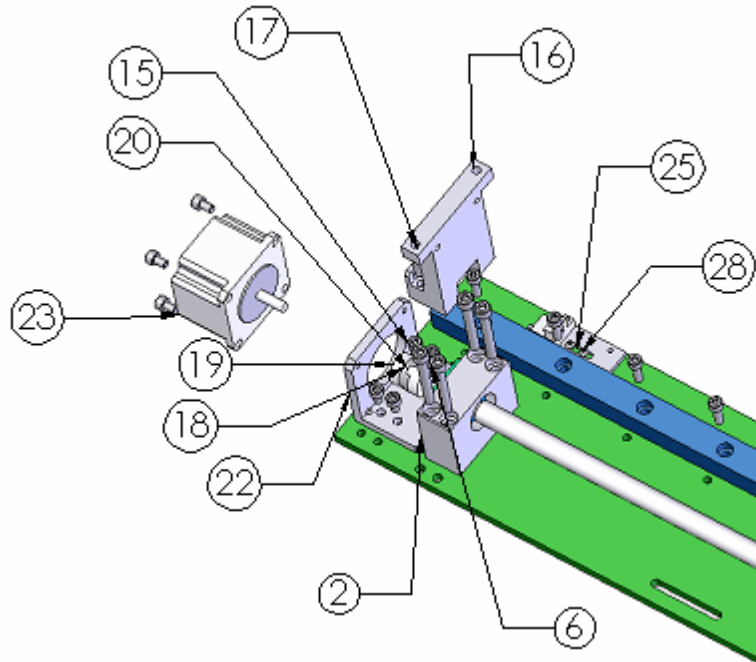

Item No.	Qty	Agilent Part Number	Description
1	1	5186-5075	Base Plate
2	1	5186-5288	AWA Fixed Support
6	6	5186-4098	M6X40 SHC A2
7	1	5186-5287	AWA Adjustable Support
10	1	5186-4544	Ballscrew
11	1	5186-1665	Linear Bearing 605MM6R SSR20
13	10	5186-2901	M6X12 SHC A2
14	1	5186-0156	NC Adjustable Rail Mounting Block
15	12	5186-2901	M6X12 SHC A2
16	1	5186-0157	NC Fixed Rail Mounting Block
17	2	5186-3991	M6X30 SHC A2
18	1	5186-2398	Oldham Thru Bore Disc 8mm
19	1	5186-2396	Oldham Thru Bore Hub 6.35mm
20	1	5186-2397	Oldham Thru Bore Hub 8mm
21	1	5186-0283	NC 1M AWA Nutbracket
22	1	5186-0285	NC 1M AWA Motormount
23	1	5186-2395	T+P Conveyor Motor (L701)
24	4	5186-4016	M4X16 SHC A2
25	2	5186-0160	NC Opto Sensor Mtg Plate
26	2	5186-1921	AWA Sensor
27	1	5186-0537	NC Int Dual Lane AWA Flag



28

6

5186-4006

M8X10 SHC A2

5186-5485 Fixed Rail Clamp/Stop Assembly & 5186-5474 Adjustable Rail Clamp/Stop Assembly

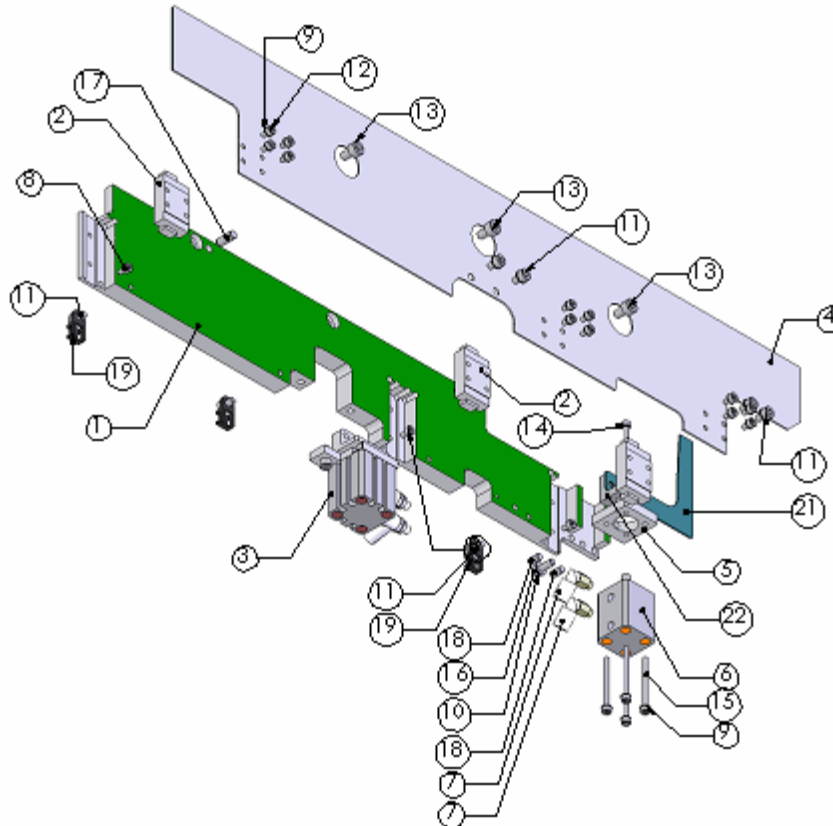

Item No.	Qty	Agilent Part Number	Description
1	1	5186-5476/5483	Adj & Fixed Clamp Back Plate
2	3	5186-5482	Clamp Blade Linear Guide
3	1	5186-2328	Clamp Cylinder
4	1	5186-5475	Single Clamp Blade
5	1	5186-5479	Stop Cylinder Mount Bracket
6	1	5186-5484	Stop Cylinder
7	2	5186-2300	KQL04-M5 Fitting
8	3	5186-3981	3X6 SHC A2
11	7	5186-3989	4X8 SHC A2
12	12	5186-3981	3X6 SHC A2
13	3	5186-4022	5X12 SHC A2
14	1	5186-3982	3X8 SHC A2
15	4	5186-4392	3X40 SHC A2
16	1	5186-3982	3X8 SHC A2
17	2	5186-1615	Dia 5x10mm Dowel
18	2	5186-5520	Dia 4x8mm SHC A2



19	4	5186-1707	Cable Tie Platform
21	1	5186-5477	Stop Blade
22	1	5186-5481	Stop Blade Holder

Clamp Cylinder Assembly

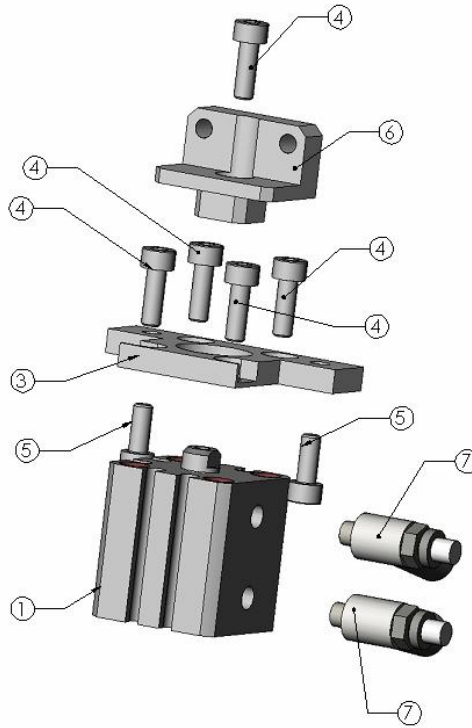

Item No.	Qty	Agilent Part Number	Description
1	1	5186-2328	Clamp Cylinder
3	1	5186-5478	Clamp Cylinder Mount Bracket
4	5	5186-3989	M4x8 SHC A2
5	2	5186-3989	M4x8 SHC A2
6	1	5186-5480	Blade Holder
7	2	5186-2299	Flow Control



Part Identification for conveyor with old board clamp/stop assembly

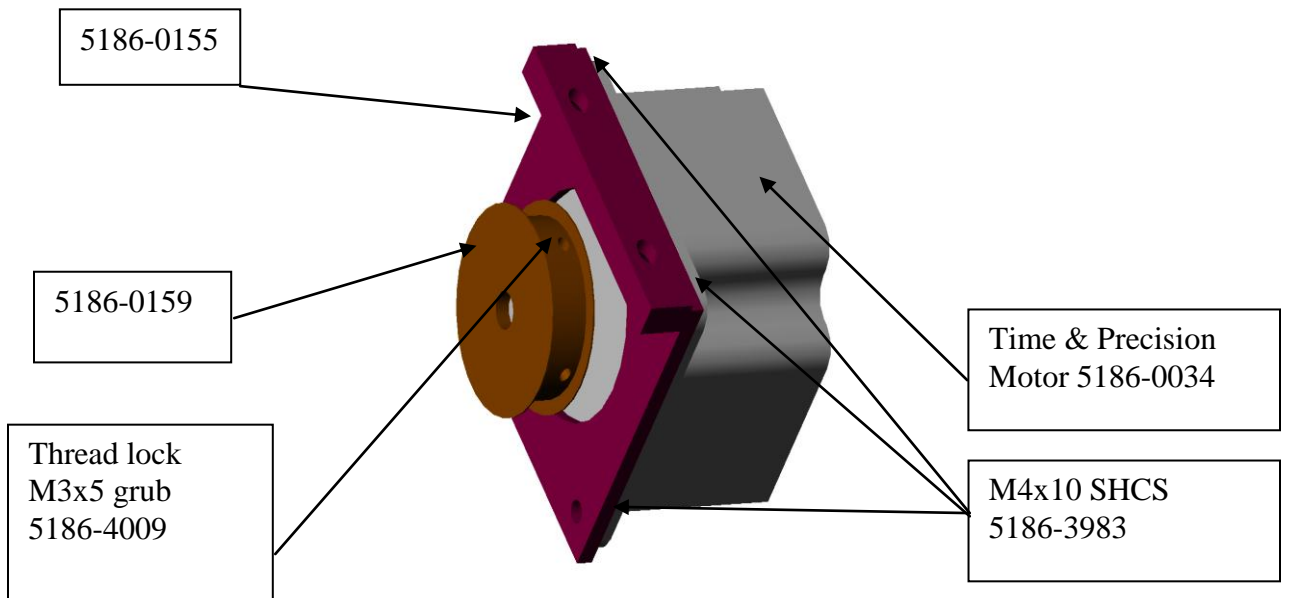
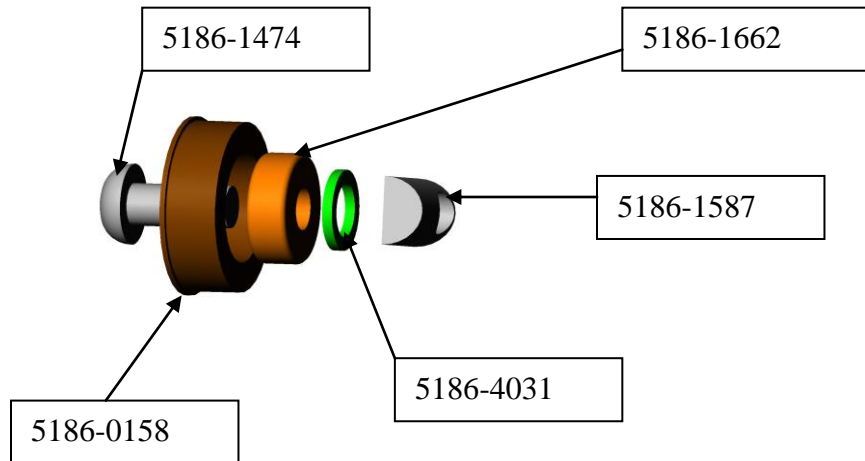

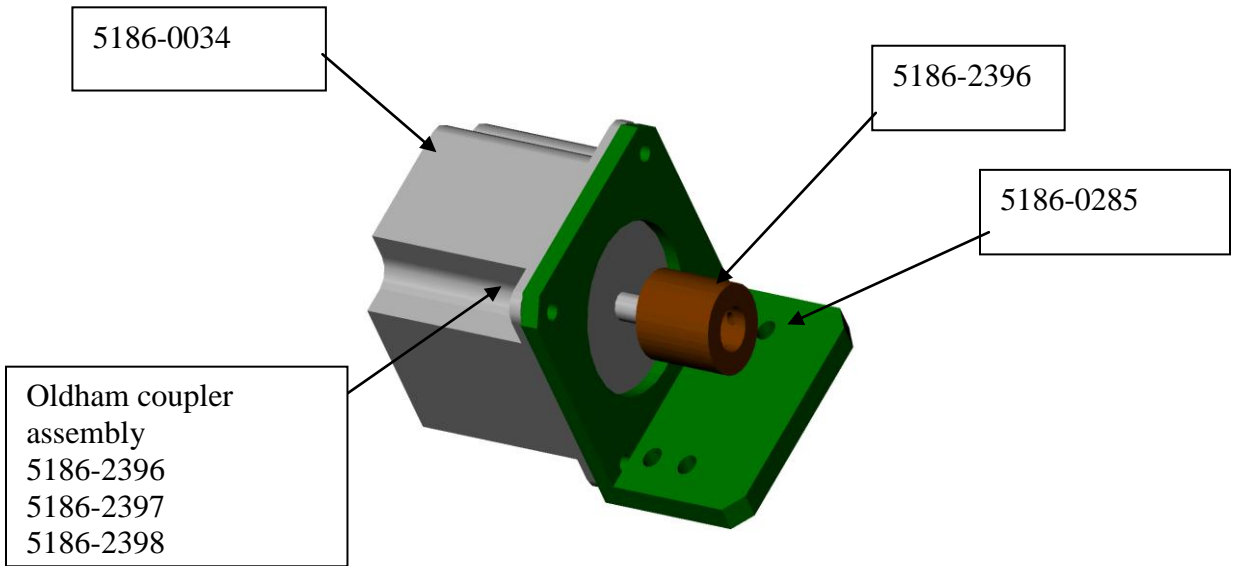

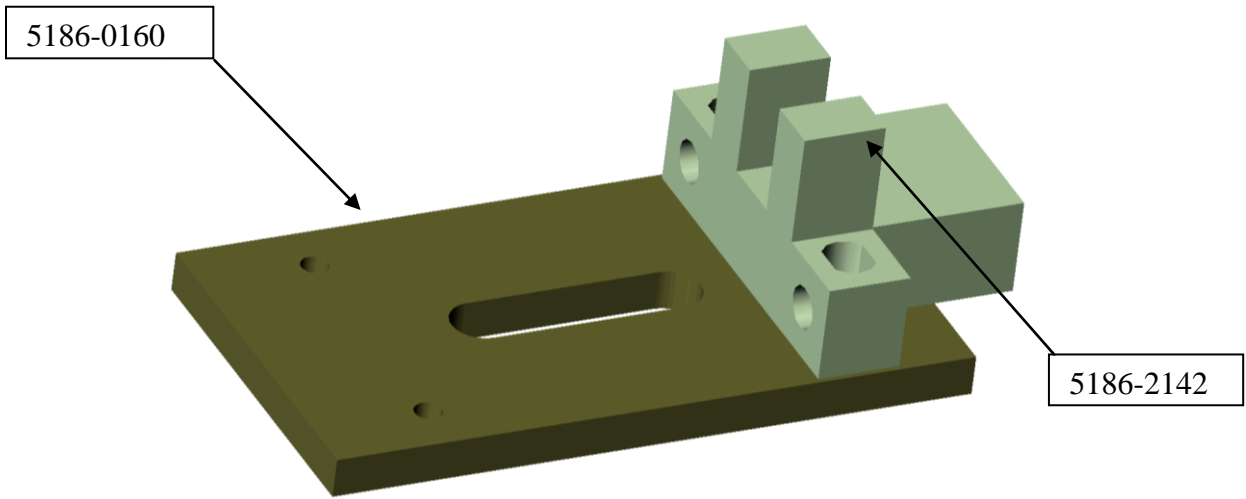
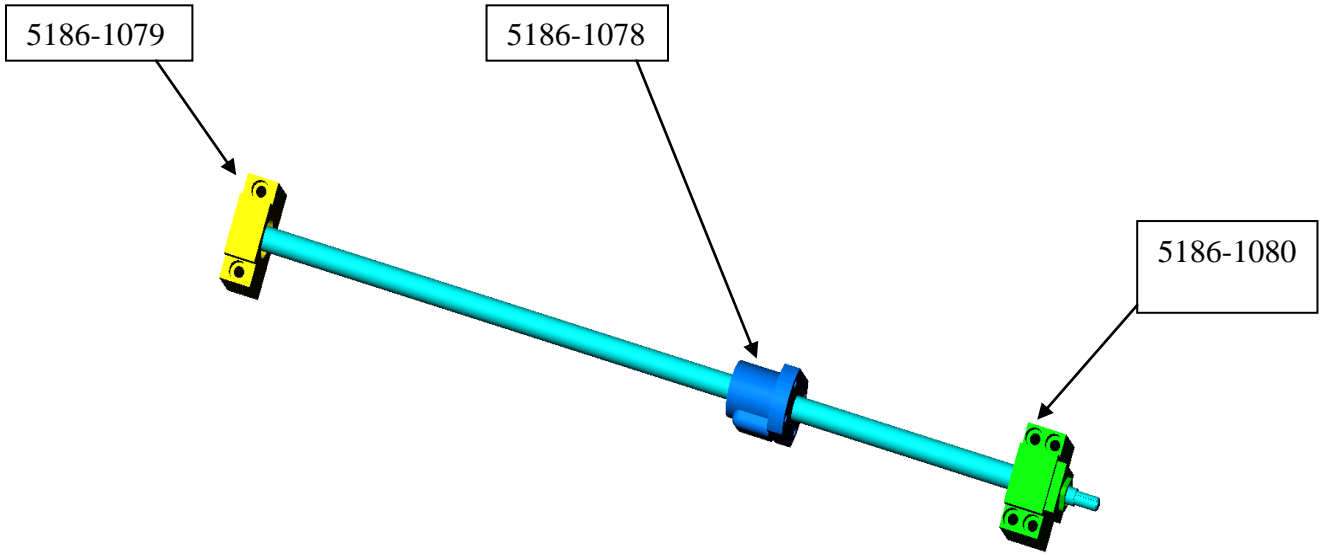

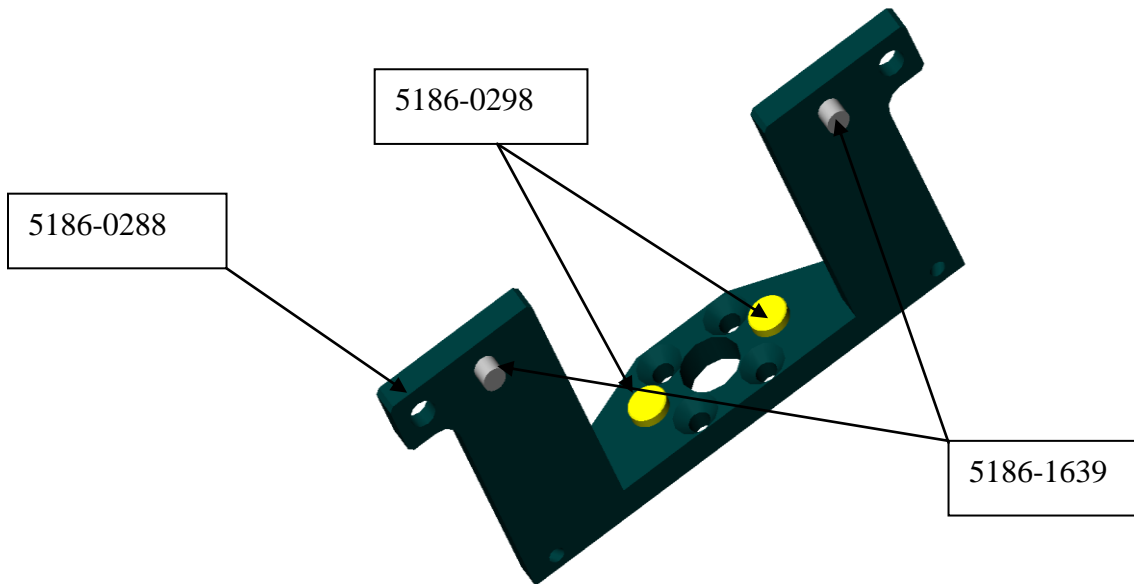
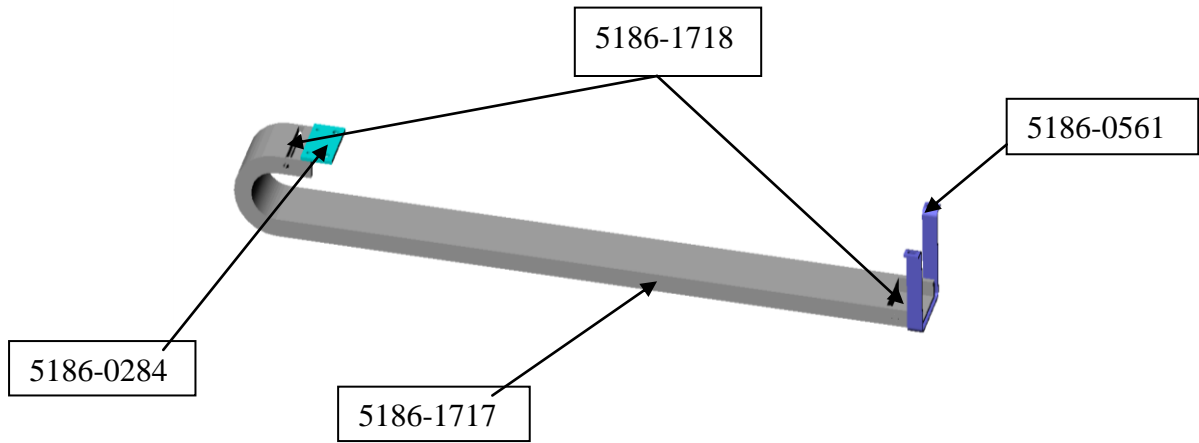

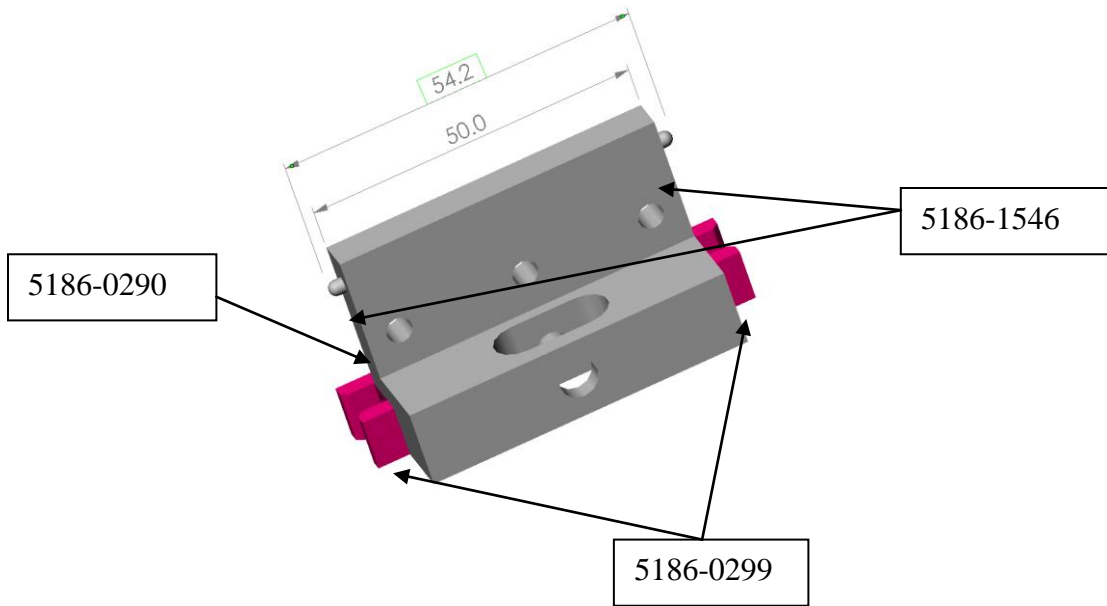

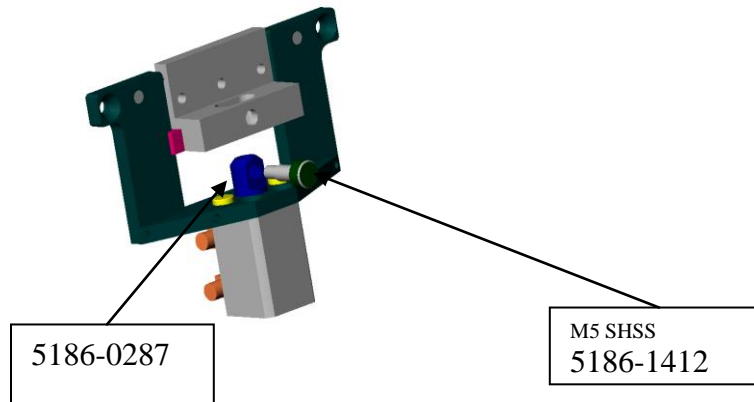
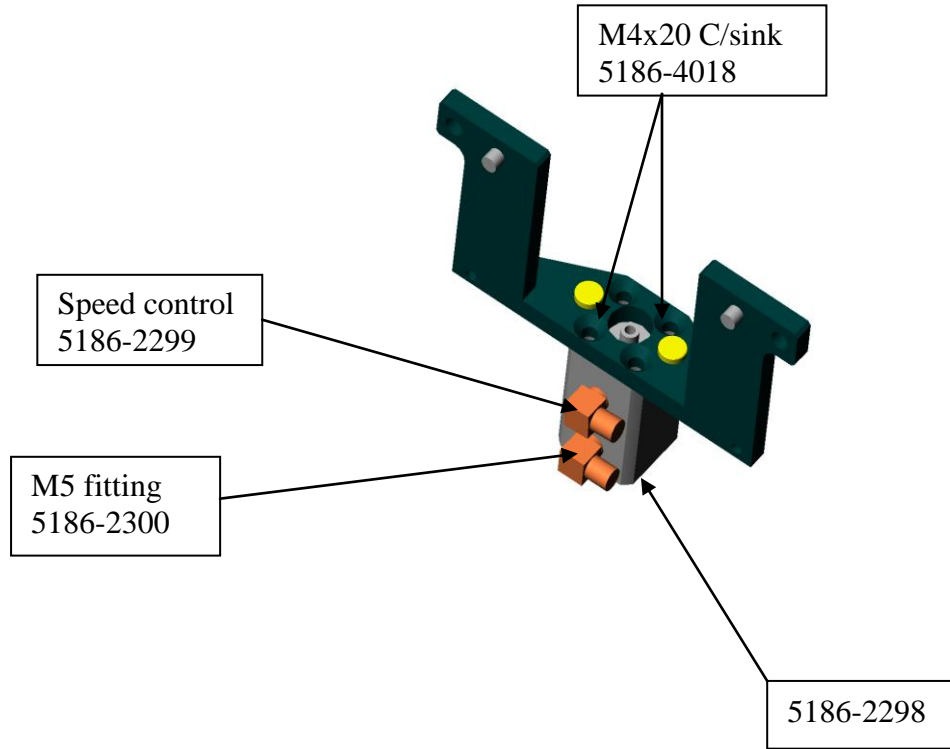

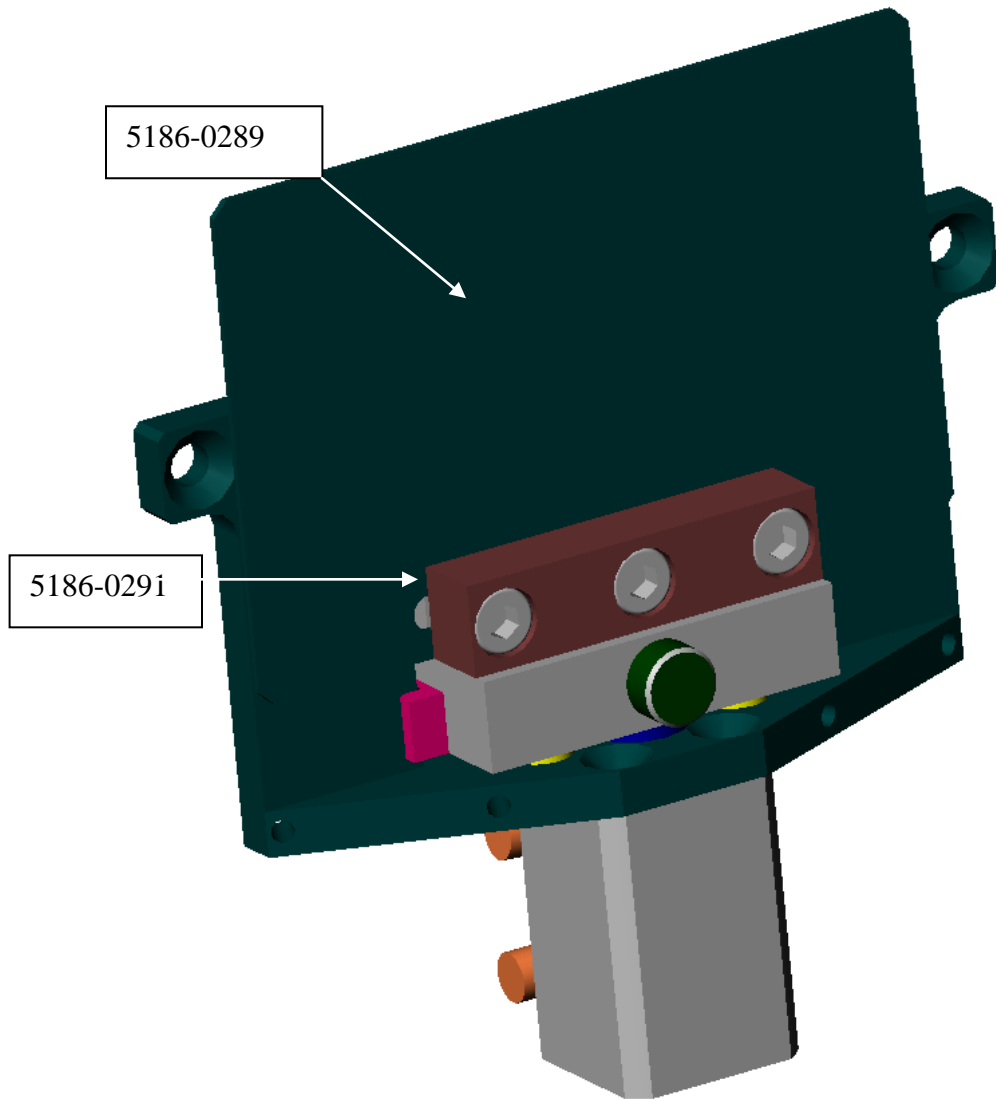

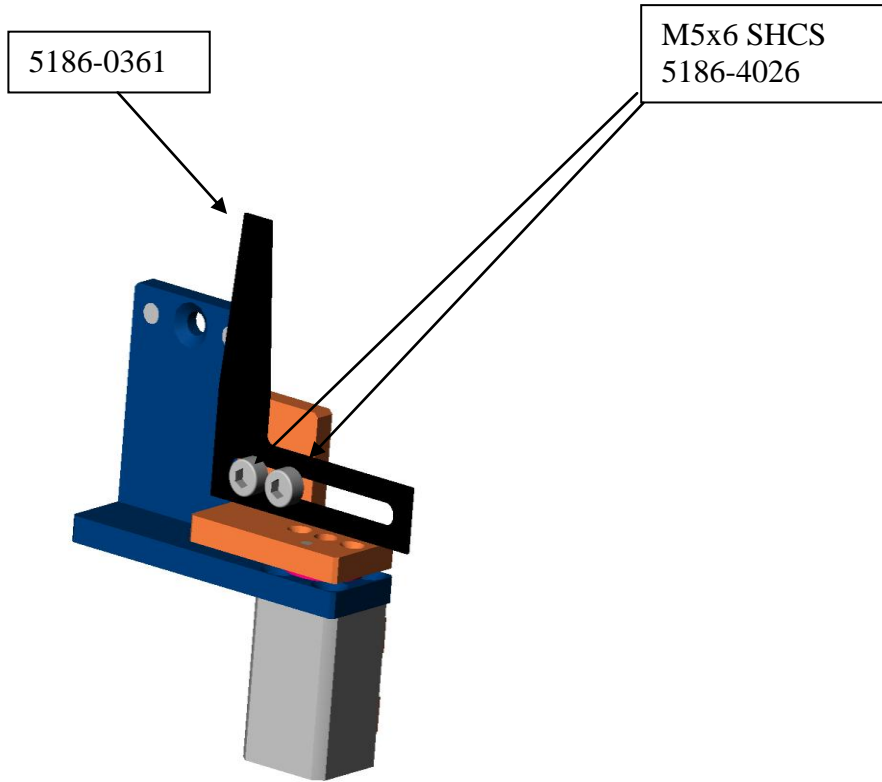
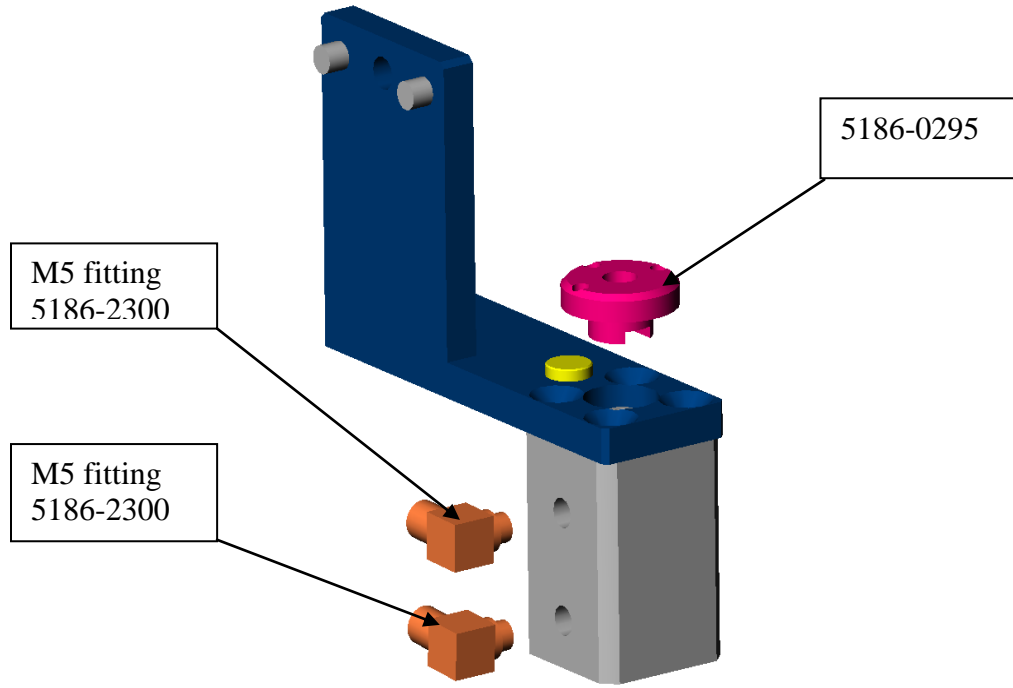



5186-1101

